



LARGE FRAME

with Optional Full Support Front Wheel Attachment



Princess

THE PROVEN LEADER IN PET MOBILITY

Thank you for purchasing a Walkin' Wheels® Large dog wheelchair.
Questions or comments? Call us at:
(603) 577-8854 or email us at: HelpMe@WalkinPets.com

Contents

Quick Start Guide	3
Parts of the Walkin' Wheels® Rear Large Wheelchair	4
Teach Your Dog How to Use Walkin' Wheels®	5
Setting Up the Dog Wheelchair	7
Use Snap Buttons to Adjust Length, Width, and Height.	8
Adjusting the Length	9
Is the Length Correct?	9
Adjusting the Width	10
Attaching the Struts and Wheels	10
Adjusting the Height	10
Stirrups.....	11
Clip the Leg Rings to the Wheelchair	12
Front Harness Attachment	13
Changing Pocket Placement of D-Ring	13
Is the Wheelchair Adjusted Properly?	15
Optional Set Screws for Noise Reduction.....	16
Belly Belt, if Needed	16
Wheel Options	17
Foam Wheels 12" and 16"	17
Air Tires Available in 12" and 16"	17
Walkin' Wheels® Front Wheel Attachment	18
In the Package	18
Assembling Fully Supportive Wheelchair	19
Putting Your Dog into the Fully Supportive (Quad) Wheelchair	22
Wear, Maintenance, Liability & Guarantee	23
Optional Items and Accessories	24
Handicapped Pets Foundation, License Plate, & Miracle Dogs book....	27

Quick Start Guide

1. Set up wheelchair length (p.9), height (p.10), and width (p.10)
2. Attach Leg Rings to wheelchair (pp.11-12)
3. Put on Front Harness on dog (p.13)
4. Put dog in wheelchair:

Now that your dog is wearing the front harness, he/she is ready to get started. The wheelchair should be positioned with extenders on the ground. Get behind the wheelchair, lift back legs up, and place dogs legs into the leg rings. When the legs are through the rings, pull up extenders (side bars). Slide each extender through the D-Ring on the front harness, and clip in place.

Video:

[www.handicappedpets.com/
large-dog-wheelchair-instructional-videos](http://www.handicappedpets.com/large-dog-wheelchair-instructional-videos)

5. How to fit dog (adjustments p.15)

Tips for adjusting length and width while dog is in wheelchair:

Rear toe pads just touch ground

Side extenders do not go past front leg

Rear width is same as chest width



Parts of the Walkin' Wheels®

Rear Large Wheelchair



Aluminum
wheelchair frame; Width
Connector installed



Width Connectors.
The 9" connector is
installed in the frame



Length Extenders.
The 26" extenders are
installed in the frame



Knuckle
(attached to frame)



Tool kit with Allen wrench
and cup screws for noise
reduction (use if desired)



Leg Rings for
rear support



One Belly Belt
for mid-section
support
(use if needed)



Stirrups to keep feet from
dragging (use if needed)



Front Harness with
comfort sleeves,
fully adjustable



Wheels attached to Struts (one set for each wheelchair)
12" and 16" shown here

Teach Your Dog How to Use Walkin' Wheels®

We created the Walkin' Wheels® with the intention that you will adjust the wheelchair, put your pet in it, and in a few moments watch him or her running and playing again. It can happen that way, but it doesn't always. A wheelchair can be an adjustment for an animal. To some, there is a strange device following him or her around making odd noises and getting caught on furniture and doorways. They will adapt to these changes, but need a little time.

We recommend you be calm, quiet, and slow when putting on the wheelchair for the first time. Give your pet lots of stroking and reassurance. Treats help, too! Let the dog get used to the harness before attaching it to the wheelchair. It may take a few minutes or a few hours for your dog to get used to the harnesses.



1. When starting this process we suggest that you use the dog's favorite treats to reward your dog for walking forward. You won't need to keep using these treats every day, just in the beginning of the training process. A hungry dog is a motivated dog! Work with your dog before you have fed him a meal. He will be more eager to pay attention and earn the food reward if he is hungry.
2. Do not immediately put your dog in the wheelchair. Assemble the wheelchair and leave it in an area where your dog can see it, smell it, and touch it.
3. Once the dog is comfortable near the wheelchair, put the front harness on and leave him or her alone for a while. Let the dog get used to the feeling of the straps.
4. When your dog is comfortable, try putting him in the leg ring support system and attach the front harness to the wheelchair. Give him a treat for positive association.
5. After your dog is in the wheelchair, hold the food reward right at his nose level. Feed him several pieces. Then you can move one foot backwards, again holding the food reward in front of you. He should then walk toward you to get the treat. Before you know it, he is walking in his Walkin' Wheels®! Again, give him a treat and positive praise.
6. Work in very short (5-10) minute sessions, several times a day. Give your dog rest periods between each session.

Note: *Keep in control of the dog's movement at first. Keep the dog in a clear area and keep him on a short leash. If the dog does become frightened, then disconnect the harness from the wheelchair and try again later.*

Until your dog gets used to the Walkin' Wheels®, limit the amount of time spent in it. The Walkin' Wheels® is designed to allow your dog to get exercise and physical therapy. Dogs cannot lie down in the wheelchair but will be able to urinate and defecate while in the wheelchair. Start with short periods and increase slowly. Make sure you don't overdo it the first day.

Setting Up the Dog Wheelchair

Adjusting the Knuckle

The frame is shipped flat. Set the legs perpendicular to the frame by turning the dial caps counter-clockwise to loosen the knuckle assembly. Don't remove the dial caps. Move the leg to the correct position using the raised indicators as your guide. The inside indicator should be in the center of the two outside indicators as shown in the photo below. Once the leg is in the correct position, tighten the dial cap by turning clockwise. Reverse this when you want to fold flat for easy storage or transport.



Correct
Straight
Leg Position

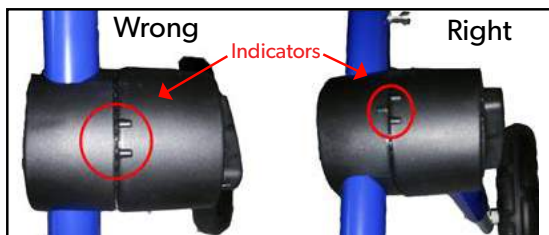

If only two raised indicator marks are visible, this means the wheelchair is upside down. Flip the leg 180 degrees.



For active dogs, you can angle the wheels back a notch (see photo).



Don't angle the wheels too far back as it will put too much pressure on their shoulders.

Angle of the legs

Normally, the wheels are set straight up and down as shown on the black dog. Setting the wheels back slightly, like the tan and white dog, will offer a bit more stability for stronger, more active dogs, or dogs who are shifting their weight back toward their hindquarters.



Use Snap Buttons to Adjust Length, Width, and Height.



The Snap Buttons are an easy way to adjust the length, width, and height of the Walkin' Wheels® dog wheelchair. Use a pen to push the Snap Button when it is inside the knuckle to make adjustments.

Adjusting the Length

Note: If you have the Front Wheel Attachment, remove the extenders and skip to p.18.



The extenders are for length adjustments. The kit comes with one set. To adjust the extenders, depress the snap button and move to desired length.

Is the Length Correct?

The end of the extenders (black cap) should be positioned at the center of the dog's shoulder blades. The extenders should be touching the neoprene pads on the front harness and not pulling outward.

If the sides tilt up, then loosen the blue strap on the front harness over the dog's back, and tighten up the red bottom strap.

If the extenders tilt down, loosen the red bottom strap, and tighten the blue strap over the dog's back to raise extenders.

The side extenders should be parallel to the ground and in the middle of the dog's body.



INCORRECT



INCORRECT



CORRECT

Adjusting the Width

Use the snap buttons on the width connector to adjust the wheelchair to the proper width. There should be at least $\frac{1}{2}$ " on each side of the hips. The width adjustment will be determined by the widest part of the dog which is usually the chest. The width connector that is attached to the frame is 9" long and will extend to 14.5". If you need additional width, call us to order the 13" connector.



Attaching the Struts and Wheels

You received your wheelchair with the correct size strut and wheel combination according to your dog's fold of flank measurement. Insert the strut into the wheelchair leg and adjust to the height needed. If you need a different size wheel and strut, contact us.



Adjusting the Height

The correct height setting is based on both the height and the condition of the dog. If the dog has some use of his/her back legs, then use the snap buttons to adjust the height so the dog's toe pads are on the ground and the dog can participate in the walking motion. If the back legs are very weak or paralyzed, and scraping or knuckling under, put the legs in the stirrups or protect them with Walkin'® Pet Boots.

Stirrups

Stirrups are optional for paws that are dragging or knuckling under. The stirrups attach to the back of the wheelchair on each silver metal loop (also called “eye pads”). The rubber tubes on the stirrups need to be above the dog’s hock. Use the push lock to adjust to a snug fit. The dog’s leg should be several inches off the ground. You can adjust the length of the cord by re-tying the knot. If you use the stirrups, use both. Using only one stirrup causes the dog to feel unbalanced.

IMPORTANT:

When taking the dog out of the wheelchair, make sure to release the stirrups **FIRST**.



hock



Rear Support Leg Rings



The Leg Rings support the dog’s hindquarters. They will take the weight off your pet’s legs while still allowing him or her to use their legs to maintain muscle mass. The Leg Rings should hang no lower than 3" below the frame. This should create a firm ‘seat’ or saddle for the dog in order to support the dog properly.



legs go
inside
each ring



Correct



Incorrect

When the dog is in the Leg Rings, the wheelchair knuckle should be at mid-hip level. The Leg Rings should look like two C’s and not two V’s with the center connector holding them together.

Clip the Leg Rings to the Wheelchair



Shoulder
Socket
screw



The Leg Ring straps go over the frame, and the black plastic harness clips have a slot that fits over the Shoulder Socket screws. Put your thumb into the round circle and push upward to lock (you will hear it click into place). The round circle will face the ground. The dog's legs go through each ring. To release, put your thumb in the circle and pull downward. Now, you can slowly lower your dog to the ground. The excess Velcro strapping will cross over the dog's back, or Velcro together to form handles (see photos below).

The Velcro center connector can be moved forward or backward to avoid putting pressure on the dog's genitals (ideal for intact dogs). In addition, the Velcro connector can be wrapped loosely so there is space between the rings. The Velcro center connector **MUST** be used. Adjust for best comfort and fit. Handles (see p.5) may be used to clip into rings on leg rings, to use as a harness when the dog is not in the wheelchair.



Excess Velcro® strapping
can criss cross over rump.
or

Velcro® two sides
together to form handles.



The rubber tubing can be cut shorter if needed (**do not cut the strapping**). Try cutting about an inch off all four ends of the rubber then adjusting the tri-glides on the straps to tighten them up.



Front Harness Attachment

Adjust the extenders so they reach the harness clips on the front harness. The extender ends will go **through** each D-Ring and then clip into the front harness. The D-Rings should be positioned just behind the shoulder blades.

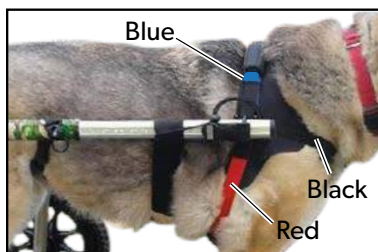

Adjusting the Front Harness:

- Take the 3 black comfort sleeves off the harness so you can make sizing adjustments.
- Dog's head goes between the black strap and the blue strap.
- Blue strap goes over the dog's shoulder.
- Red strap goes behind the front legs and clips into the side of harness.
- Black strap goes under neck across front of chest.
- Side neoprene panels should be positioned over the shoulder blades.
- Male prong clips point to the back.
- All three straps should be snug.



Comfort sleeves can be cut for smaller dogs and excess straps tucked in. This material will not fray.

Changing Pocket Placement of D-Ring (optional)

Note: Unless advised to change pocket by a Walkin' Pets customer service representative, keep the clip in **middle** pocket because the straps are adjustable. Needed: small Phillips screwdriver to remove (2) screws, if changing the position of the clip.

Before starting, observe which direction the prongs are facing on the D-Ring. They should always face the rear end of **dog**.

Parts:



(A) Bottom of Slide Clip



(B) Top of Slide Clip



(C) D-Ring



Step 1: Remove (2) screws from (B) top Slide Clip



Step 2: Push out (B) top piece which holds (C) D-Ring



Step 3: Remove (A) bottom piece from middle pocket and replace into desired pocket



Step 4: Connect (C) D-Ring to (B) top piece and slide into (A) bottom piece



Step 5: Replace screws (2) on opposite side of entry point

Is the Wheelchair Adjusted Properly?

Check the items below to make sure the wheelchair is fitted properly. If you are still unsure about the fit, please email rear and side view photographs of your dog in the wheelchair to:

HelpMe@WalkinPets.com, and we will evaluate the fitting. Make sure you include what name the wheelchair was ordered under and your phone or sales receipt number.

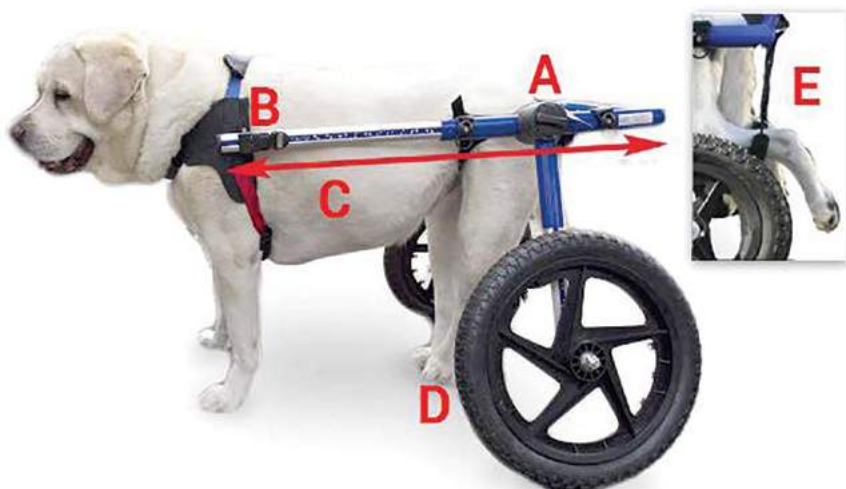

When the wheelchair is adjusted properly, the dog stands in a natural position. Here is what to check:

- A** Knuckles should be in line with the hips.
- B** Front harness D-Ring clips: clip into extenders behind shoulder blade. Back should be straight.
- C** Extenders parallel to the ground and do not extend past the front legs (see photo on bottom of p.9)
- D** Toe pads touching the ground, or
- E** Toe pads put into stirrups above hock.

Optional Set Screws for Noise Reduction

Using the set screws will tighten up your wheelchair and reduce any rattling noises. The set screws also keep the wheelchair tight after it has been adjusted for your dog. When you tighten up the wheelchair, the side arms, called extenders, will be able to move up and down as your pet turns corners. This is completely normal. The flexibility also allows for ease of movement on uneven terrain. There are six places to put the set screws using the Allen wrench. They are indicated below with red arrows.

Note: Make sure the set screws shown below are loosened or removed before making adjustments.

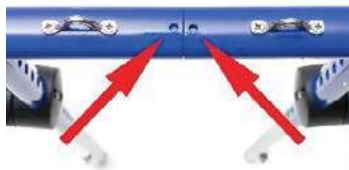

Belly Belt, if Needed

Some animals will need additional support under their belly. You can determine if the dog needs additional support if their spine bows downward. It is also helpful for overweight dogs or dogs with spinal or disc issues. One end of the belly belt has a tri-glide (rectangular with bar in the middle) attached and the other side has Velcro strap-
ping. Both sides have a rope with a push button adjuster (instructions on p.17).

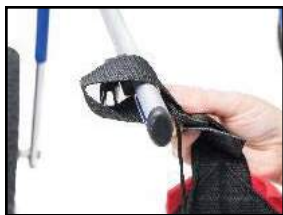

Figure A



Figure B



Figure C

- A. Take the side with the tri-glide and put the extender through the end of the loop.
- B. Take the rope and put inside the harness clip on the extender (B). Then, attach the front harness to the harness clip in order to secure the rope. This will keep the belly belt from sliding backwards. Now, adjust the belly belt so it is in the middle of the dog's belly.
- C. Secure the other side over the extender and Velcro to bottom of belly belt. The purpose of the belly belt is to provide support for your dog's mid-section.

If your dog needs more support, you can purchase the Walkin' Belly Support:
www.WalkinPets.com/walkin-belly-support



Wheel Options

We offer two size wheels: 12" and 16"

Air Filled vs Foam Filled



Foam Wheels: 12" and 16"

- Lightweight, high density foam material that offers a smooth ride
- Wear extremely well and will never go flat
- Made for all terrain
- 12" and 16" wheels have ½" hub with bearings
- True closed-cell technology/ no water absorption
- Easy to clean

Air Tires Available in 12" and 16"

- Ideal for active dogs that do off-road hiking
- Offer more shock absorbency
- Similar to mountain bike tires with deep treads
- Will need to replace tubes or wheels if punctured
- Require 30 PSI air: use airpump at gas station
- 12" and 16" wheels have ½" hub with bearings
- Additional cost

This section is for assembling the Fully Supportive (Quad) wheelchair

Walkin' Wheels® Front Wheel Attachment

(additional cost)

The Walkin' Wheels® Front Wheel Attachment gives mobility to dogs with front leg weakness or weakness in all four legs. It is ideal for helping disabled pets get exercise and for rehabilitation while they are healing.

Like the rest of the Walkin' Wheels® products, the Front Wheel Attachment is adjustable so it will fit the Walkin' Wheels® wheelchair for any size dog from 70 to 180 pounds and can be easily removed at any time.



In the Package

The Front Wheel Attachment is easy to assemble and snap into the wheelchair. You will need a Phillips head screwdriver. The package contains:



- A** Left and Right Extenders (2)
- B** Struts and Casters (2)
- C** Legs (2)
- D** Chin Bar & Extension pieces (3)
- E** Allen Key/Wrench (2)
- F** Front Bar Screws (2)
- G** Chin Bar Comfort Cover (1)
- H** Front Leg Rings (1 Pair)

IMPORTANT: The LEFT and RIGHT Struts and Casters (**B**) must match the LEFT and RIGHT Legs (**C**). If they are not installed correctly the wheelchair will be extremely wobbly. We refer to **L** and **R** as if you are in the wheelchair.

Assembling Fully Supportive Wheelchair

Video instructions also available:

www.WalkinPets.com/

[instructional-videos-large-fully-supportive-dog-wheelchair](#)

Step 1: Attaching the legs (**C**) to the extenders (**A**)

The top of each leg is labeled with an L or an R. It is crucial that the legs are installed on the correct side. The extenders are not labeled L or R, but the shoulder socket screws face the outside.

Attach the leg to the extender with (2) screws using the larger Allen key. The legs will be at a forward angle.

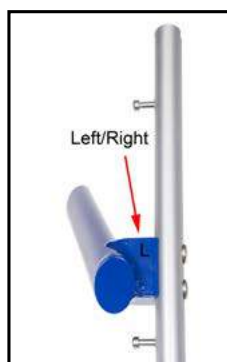
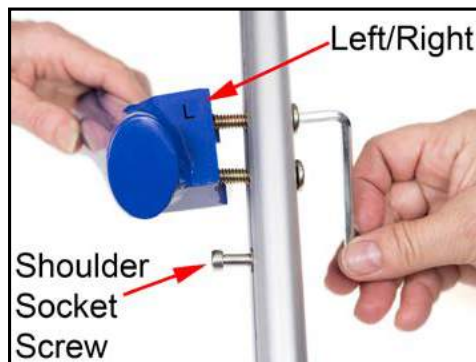

Step 2: Length Extenders

Remove the existing Length Extenders from your rear Walkin' Wheels® and snap in the left and right Front Extenders (A).

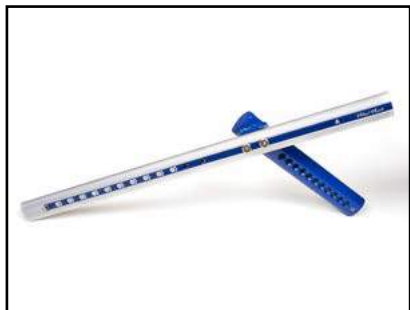

Step 3: Insert the Strut and Caster Assembly (B) into the Leg (C)

These are marked with "L" and "R." It is very important that they are installed on the correct sides.



Important: Notice the blue ledge on the Caster Connector. This needs to be facing outward in order for the Front Wheel Attachment to work properly.

Step 4: Adjust the Chin Bar (D)

Note: Use of the Chin Bar is optional. The Chin Bar adds stability and rigidity to the Front Wheel Attachment. It needs to approximately match the width of the back of the Walkin' Wheels®. Use a Phillips head screwdriver to remove the two screws on the Chin Bar and adjust it so that the width of the Chin Bar is approximately the same as the width of the back of the wheelchair. Insert screws to secure in place.



The Chin Bar attachment only has threads on one side of the bar. You will notice that the bar with the large holes has no thread. That is the side the screw needs to feed through.

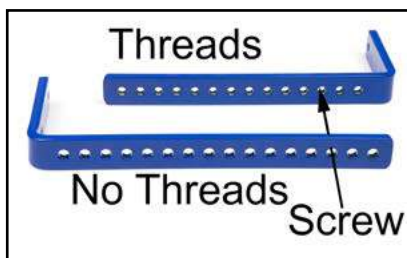

Attach the extension piece to the outside of the Chin Bar using the included screws and washers.

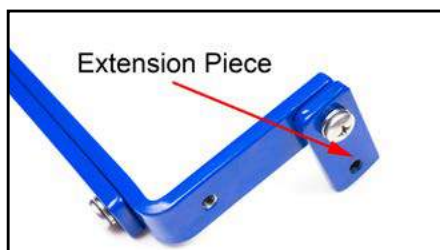

Insert the Chin Bar into the openings at the front of the **Left and Right Extenders** using the thumbscrews. The **Chin Bar** is held on by the two **Chin Bar Screws (F)**. Put the **Chin Bar Comfort Cover (G)** on the **Chin Bar**. Chin Bar is attached after the dog is in the wheelchair using the thumb screws through the metal extenders.



Step 5. Clip on the Front Leg Rings (H) the same way you attached the rear leg rings.

Putting Your Dog into the Fully Supportive (Quad) Wheelchair

There are many ways to get your dog into the Fully Supportive wheelchair. We suggest that you view the video on our website for some ideas, found at this link:

www.WalkinPets.com/instructional-videos-large-fully-supportive-dog-wheelchair

Height – Set the height so that the dog's toe pads are touching the ground. Extenders need to be parallel to the ground.

Length – Dog's front leg should be centered between the two shoulder socket screws.

Width – Width is determined by the widest part of the dog (generally the dog's chest). Allow at least an inch of space on both sides.

Leg Rings – The leg rings in the front generally need to be a bit lower than in the rear to accommodate the dog's deeper chest.

Adjust the leg rings accordingly.



Wear, Maintenance, Liability and Guarantee

Maintenance

With proper use and maintenance, the wheelchair is designed to last a lifetime. When you need replacement parts for the wheels, harnesses, and other wear-and-tear items, they may be purchased at:

WalkinPets.com/spare-parts. The wheelchair frame will not rust. If dirt or sand gets inside the wheelchair, you can hose it off. All components can be removed and cleaned. Oiling is not necessary.

Limited Liability

Walkin' Wheels® is provided as a walking aid for animals that are under the care of a veterinarian and for which a dog wheelchair has been recommended. Wheels for Pets, LLC, and its affiliates, agents, and distributors make no representation to the effectiveness or appropriateness of this product.

Maintenance videos

You Tube Links:

On You Tube, search "handicappedpets.com"

Click on the first result "Walkin Pets Logo"

Click where it says "Playlist"

Click wheelchair maintenance full view playlist

Guarantee

The Walkin' Wheels® wheelchair frame is guaranteed by the manufacturer, Wheels for Pets, LLC, for five years from the date of purchase against defects in material or workmanship. If the frame breaks under normal usage, please let us know and we will repair or replace the wheelchair at our option. You are responsible for all shipping charges. Warranty is non-transferable.

Return Policy

If you try the wheelchair and it does not work for your pet because of the design or fit, call us within 30 days from the day the wheelchair arrived. If we can't correct it, we will issue a return authorization number (RA). If refurbishing is needed due to scratches or wear, this will reduce your refund. The RA# must be written on the outside of shipping box or a refund will not be considered. A Return Authorization Form must be filled out in order to get your refund. This form is included in the "Important Document" plastic sleeve on the outside of the shipping box:

www.WalkinPets.com/return-policy-walkin-wheels

Optional Items and Accessories

Walkin'® Lift Combo Harness

www.WalkinPets.com/walkin-lift-combo-harness



The Walkin'® Lift Combo Harness provides complete lifting assistance and mobility support for a dog's front and rear legs. Fully compatible with the Walkin' Wheels® dog wheelchair. Front and Rear harnesses can be sold separately.

Walkin'® Lift Harness

www.WalkinPets.com/walkin-lift-rear-harness



The Walkin'® Lift Harness is used to support your dog's hind quarters. This harness is compatible with the Walkin' Wheels® wheelchair, and can be used instead of the Leg Rings. This rear harness is great to use to assist your dog. The clip-in handles are used with this harness.

Walkin'® Pet Boots and Stirrup Kit

www.WalkinPets.com/boot-as-stirrup-kit



Combining the Walkin'® Pet Boots with our stirrup adapter provides the most comfortable wheelchair experience for your pet. This product is good for dogs that want to use their rear legs, but also need to hold them up after a period of time due to fatigue.

Amputee Cover

www.WalkinPets.com/amputee-leg-ring-cover



The amputee cover is for pets with a smooth amputation. It works with the leg rings. The cover slips over the leg ring to close off one side for comfort.

Walkin'® Belly Support

www.WalkinPets.com/walkin-belly-support



The Walkin'® Belly Support helps provide additional support for your pet's back while in the Walkin' Wheels® wheelchair. Made of lightweight but strong neoprene fabric, the Belly Support helps raise the middle of the pet's body to relieve undue stress on back.

Walkin'® Drag Bag

www.WalkinPets.com/walkin-drag-bag



The Walkin' Wheels® Drag Bag is designed for pets to use in the home when they are not in their chair. Great for protecting the chest and limbs. Prevents abrasions and sores that can be caused by scraping against carpets, floors, and rough surfaces.

Walkin'® All Weather Boots

<https://www.handicappedpets.com/walkin-weather-boots/>



Walkin'® All-Weather Boots provide year-round protection against temperature extremes and rough surfaces while keeping paws clean and dry. They also work well for dogs who drag their paws while in a wheelchair. These boots can be turned around, to have the soles facing the front to protect dragging paws.

Front and Rear No-Knuckling Training Socks

www.WalkinPets.com/no-knuckling-training-sock



The No-Knuckling Training Sock should be used as a temporary training tool. It is intended for short-term, multiple use to help correct gait and improve paw placement.

Walkin'® Wheelchair Leash

<https://www.handicappedpets.com/walkin-wheelchair-leash/>



The Walkin' Wheelchair Leash attaches easily to Walkin' Wheels wheelchairs to help control and guide your dog. It may also be used to walk two dogs at the same time (without wheelchairs).

Walkin'® Scooter

<https://www.handicappedpets.com/walkin-scooter/>



The Walkin'® Scooter for pets is designed to keep your pet comfortable and always on the go! It allows pets to be move freely around the house while easily maneuvering around indoor obstacles. Roller ball casters allow for easy movement in any direction!

Walkin'® Ski Attachment

<https://www.handicappedpets.com/walkin-ski-attachment/>



The Walkin' Ski Attachment, for use with the medium or large size Walkin' Wheels dog wheelchair, easily interchanges with the dog cart's standard wheels/struts to allow your dog to glide through the snow. The Walkin' Ski Attachment will help your dog have fun playing or trekking through the snow!

Walkin'® Up-n-Go Leash

<https://www.handicappedpets.com/walkin-rear-support-leash/>



The Walkin' Up-n-Go Leash helps you give your dog a lift on the end that needs it most! This rear support leash is recommended for dogs weighing 20 pounds and up.

Handicapped Pets Foundation

www.hpets.org

The Handicapped Pets Foundation is a 501(c)3 nonprofit corporation dedicated to the health and well-being of elderly, disabled, and injured pets. Its mission is to extend the life of pets by helping them move so that they can get the exercise they need to live long, happy, healthy lives; the Foundation donates wheelchairs to pets in need for this purpose.

You can help!



Donations are gratefully accepted and can be sent to:

Handicapped Pets Foundation
14 Veterans Road #22
Amherst, NH 03031

(Make checks payable to: Handicapped Pets Foundation)

License Plate for Walkin' Wheels® Wheelchair

www.WalkinPets.com/dog-wheelchair-license-plate

You can purchase a license plate for your dog's Walkin' Wheels®. Choose from dog breeds or upload your own photo for a custom license plate. The license plate can be placed on the back of the dog wheelchair to make the perfect accessory to any Walkin' Wheels®. All profit on the sale of license plates goes to the Handicapped Pets Foundation!





MIRACLES IN MOTION



105 Rt 101A, Suite 18 • Amherst, NH 03031 • (888) 253-0777
www.WalkinPets.com

Patents: US 7549398 • Japan 5385584 • Canada 2641092 • EPO 2 050 418
Trademarks: Walkin' Wheels® 4,765,026 • 4,882,354 • 3,725,405 • 4,765,026
Other patents pending and trademarks pending.